

NOZZLE SCHEDULE		
ITEM	QTY.	NAME DESCRIPTION
N1	1	INLET 2.5" - 150# RFSO ASME B16.5
N2	1	OUTLET 2.5" STD WT PIPE
N3	1	DRAIN 1"-3000# HALF CPLG.

REV	DATE	CHANGE	ECR	BY	APP
A	10/26/01	NEW ISSUE	9941	GC	VH
B	12/05/03	DELETED NAMEPL. BRACKET, NAMEPL., INLET TAG, ADDED EXHAUST HEAD NAME PL.	B892	LH	FM
C	11/1/05	REVISED TITLE BLOCK	D507	FM	LH

NOTES:

1. ALL DIMENSIONS ARE IN INCHES.
2. ALL BOLT HOLES ARE TO STRADDLE NATURAL CENTERLINES.
3. SHIPPING WEIGHT: 55 POUNDS.
4. DESIGN DATA:

- DESIGN PRESSURE- ATMOSPHERIC
- DESIGN TEMPERATURE- AMBIENT
- CORROSION ALLOWANCE- 0 INCHES
- 5. MATERIAL: CARBON STEEL
- 6. PAINT REQUIREMENT: PER ES-317.

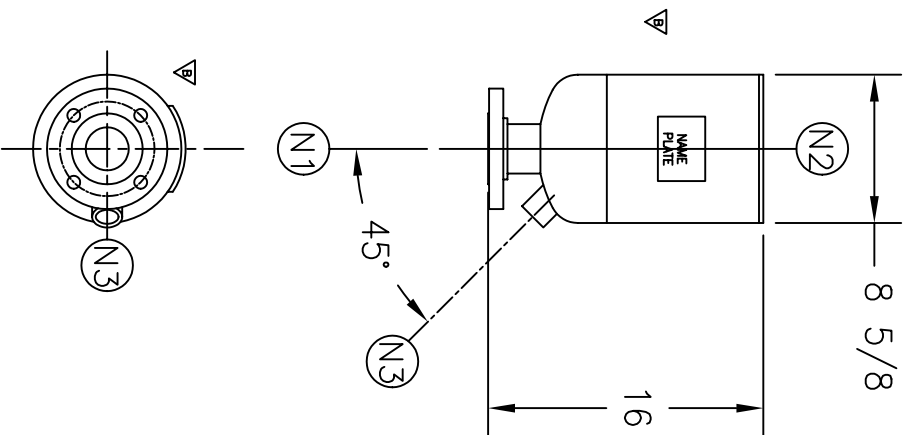

ELECTRONIC FILE NAME:  
SD2.5EHC.DWG  
TOLERANCES UNLESS OTHERWISE SPECIFIED  
PER ENGINEERING STANDARD ES- --

UNAUTHORIZED USE, MANUFACTURE OR  
REPRODUCTION IN WHOLE OR IN PART IS  
PROHIBITED. DRAWING, DESIGN AND  
OTHER DISCLOSURES PROPERTY OF  
EATON FILTRATION, LLC

<b>EATON</b>	<b>EATON FILTRATION, LLC</b>			
	900 FAIRMOUNT AVENUE, ELIZABETH, NEW JERSEY 07207			
NAME	2.5" TYPE "40-EHMF" EXHAUST HEAD 150# FLG CSTL			

CUSTOMER:  
REG. NO.:  
P.O. NO.:  
TAG NO.:  
PART NO.: 2.5EHC

DRAWN	GC	DATE	CHECKED	FJM	DATE
APP	FG	10/29/01	SCALE	1:12	ECR 9941
SIZE	DWG	SD2.5EHC		REV	C