

Unicode™ 2 Series 1-Pole Contact Block

Components for Increased Safety Enclosures

NEC/CEC:
 Class I, Division 2, Groups A, B, C, D
 Class I, Zone 1, AEx de IIC
 Class I, Zone 1, AEx e IIC

NEC/CEC:
 Class II, Division 2, Groups F, G
 Class III
 Type 4X/IP66 ①

ATEX/IECEX:
 Zone 1 and 2 – 21 and 22
 Ⓢ II 2 GD
 IP66 – IK10

CONTROLS: NEC/CEC, ATEX/IECEX INCREASED SAFETY CONTROL STATIONS

Appleton®

Features

- Globally certified.
- Available in TS35 rail mounted or panel mounted.
- High performance contact block suitable for low intensity (less than 5mA).
- Rated operating voltage (Ue): 500 Vac — 110 Vdc.
- Switching capacity:
 - AC12: 16 Amp/400 Vac
 - AC14: 10 Amp/400 Vac
 - AC15: 6 Amp/500 Vac
 - DC13: 2 Amp/24 Vdc and 1 Amp/110 Vdc
- Terminal connection: 2.5 mm² (0.004 in²)
- Operational life: 100,000 hours.

Standard Materials

- Body: polyamide
- Contact: silver alloy

NEC/CEC Certifications and Compliances

- Certification Type Cve
 - Operating Temperature: -40 °C to +75 °C (-40 °F to +167 °F)
 - Ingress Protection (solid and liquid): IP66 and Type 4X ①
 - CAN/CSA Standards: C22.2 No. 0-M91, No. 14-05, No. 94-M91, No. 213-M1987, No. 60079-0:07, No. 60079-1:07, No. 60529:05, E60079-7-03, E61241-1-1:02
 - UL Standards: UL 508, UL 50E, UL 60079-0, UL 60079-1, UL 60079-7
 - Other Standards: ANSI/ISA 12.12.01-2011, ANSI/ISA 61241-0 (12.10.02)-2006, ANSI/ISA 61241-1(12.10.03)-2006
 - CSA Certificate: 2358701

ATEX/IECEX Certifications and Compliances

- Certification Type Cve
 - Gas: Zone 1 and 2
 - Conforming to ATEX 94/9/CE: Ⓢ II 2 G
 - Type of Protection: Ex e IIC
 - Dust: Zone 21 and 22
 - Conforming to ATEX 94/9/CE: Ⓢ II 2 D
 - Type of Protection: Ex tD A21
- Surface Temperature: -40 °C to +75 °C (-40 °F to +167 °F)
- CE Declaration of Conformity: 5C243
- ATEX Certificate: LCIE 09 ATEX 3001U
- IECEX Certificate: IECEX LCI 09.0002U

EURASEC Certification

- EURASEC RU C-FR.ГБ05.В00909

Other Certification ②

- INMETRO Certificate: BVC 10.0047-U



UCB5R
 Rail Mounted Contacts
 Top Access



UCB5P
 Panel Mounted Contacts
 Bottom Access

① Overall hazardous location and ingress protection rating depends on the rating of the optional certified components used.
 ② INMETRO certification available on special request only. Contact your local sales representative for more information.

Unicode™ 2 Series 1-Pole Contact Block

Components for Increased Safety Enclosures

NEC/CEC:
 Class I, Division 2, Groups A, B, C, D
 Class I, Zone 1, AEx de IIC
 Class I, Zone 1, AEx e IIC

NEC/CEC:
 Class II, Division 2, Groups F, G
 Class III
 Type 4X/IP66 ①

ATEX/IECEX:
 Zone 1 and 2 – 21 and 22
 Class II 2 GD
 IP66 – IK10

	Weight kg (lb)		Volume dm ³ (in ³)		Pack	Catalog Number	
	Rail Mounted	Panel Mounted	Rail Mounted	Panel Mounted		Rail Mounted	Panel Mounted
1-Pole Contact Blocks							
1 x NO						UCB5R	UCB5P
1 x NC	0.032 (0.071)		0.06 (3.66)		1	UCB9R	UCB9P

Dimensions in Millimeters (Inches)

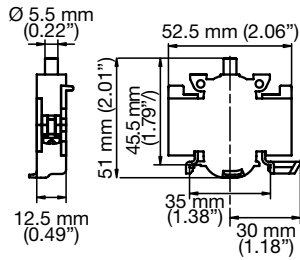

Wiring Diagram

NO

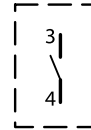

NC

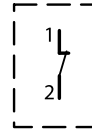

① Overall hazardous location and ingress protection rating depends on the rating of the optional certified components used.