





Pneumatically operated 2/2 way Diaphragm Valve with plastic body

- Control function convertible
- Can be used for aggressive medium
- Compact design



Product variants described in the data sheet may differ from the product presentation and description.

Can be combined with

	Type 6014 Plunger valve 3/2 way direct-acting	▶
	Type 6012 Plunger valve 3/2 way direct-acting	▶
	Type 8644 Remote Process Actuation Control System AirLINE	▶

Type description

2/2 way plastic diaphragm valve, pilot operated with pneumatic actuator and spring return. Used for polluted medium in process and water technology.

Table of contents

1. General technical data	3
2. Circuit functions	3
3. Dimensions	4
3.1. DN 15, screwed connection with Ø 20 threaded socket.....	4
3.2. DN 12, G 3/8 threaded socket, Ø 16 true union solvent or true union weld.....	4
4. Performance specifications	5
4.1. Pressure temperature diagram.....	5
4.2. Pilot pressure diagram.....	5
5. Ordering information	6
5.1. Bürkert eShop – Easy ordering and quick delivery.....	6
5.2. Bürkert product filter.....	6
5.3. Ordering chart.....	6
5.4. Ordering chart accessories.....	7
3/2 way pilot valve.....	7
Replacement diaphragms for all orifices.....	7
Cable plug Type 2507 acc. to industry standard connector Form B.....	7

1. General technical data

Product properties	
Dimensions	Detailed information can be found in chapter “3. Dimensions” on page 4.
Material	
Body	PVC-U, PP
Actuator	PP, glass-fibre reinforced
Seal	EPDM
Performance data	
Pilot pressure (max.)	Max. 7 bar, detailed information can be found in chapter “4.1. Pressure temperature diagram” on page 5
Medium data	
Operating medium	Neutral or aggressive medium that do not attack the body and seal materials
Medium temperature	Detailed information can be found in chapter “4.1. Pressure temperature diagram” on page 5.
Control medium	Lubricated/non lubricated compressed air and other neutral medium (e.g. water)
Process/Port connection & communication	
Port connection	Detailed information can be found in chapter “5.3. Ordering chart” on page 6.
Environment and installation	
Installation position	As required, preferably with actuator upright
Ambient temperature	0 °C...+60 °C

2. Circuit functions

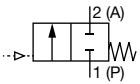
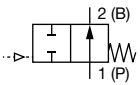
Control function	Description
	CF: A, pneumatically operated on/off valve 2/2 way Flow direction above seat Normally closed by spring force
	CF: B, single-acting actuator for pneumatically operated on/off valve 2/2 way Normally open by spring force

3. Dimensions

3.1. DN 15, screwed connection with Ø 20 threaded socket

Note:

Dimensions in mm

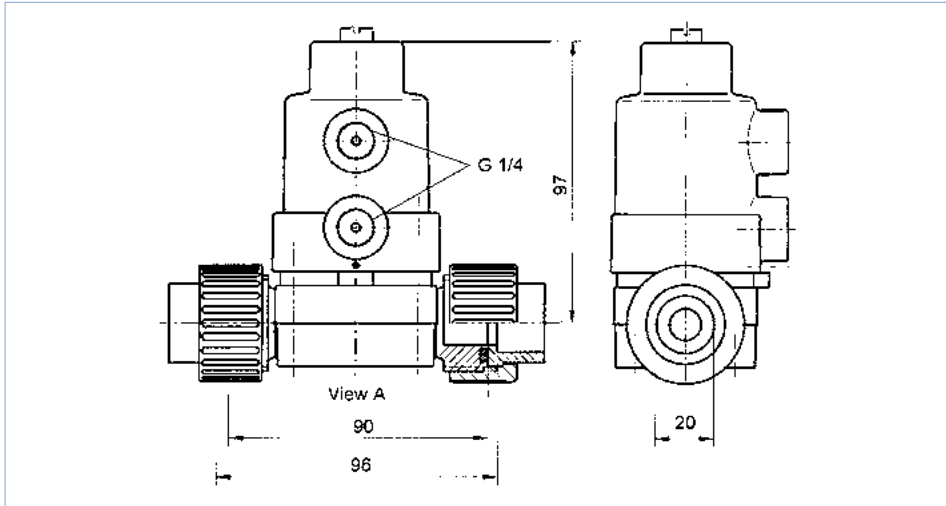

3.2. DN 12, G 3/8 threaded socket, Ø 16 true union solvent or true union weld

Note:

Dimensions in mm

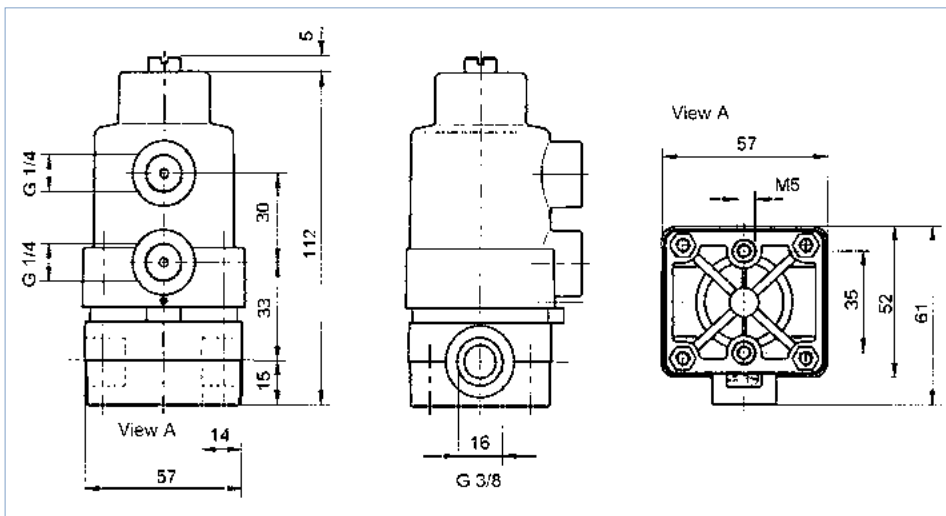

4. Performance specifications

4.1. Pressure temperature diagram

Note:

Depending on the body materials

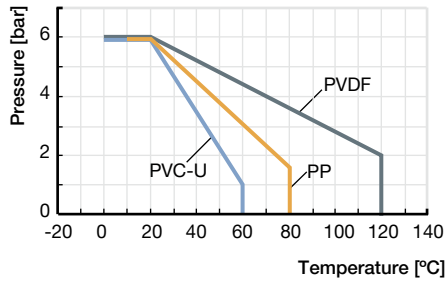

4.2. Pilot pressure diagram

Note:

NC = Control function A, NO = Control function B, DA = Control function I

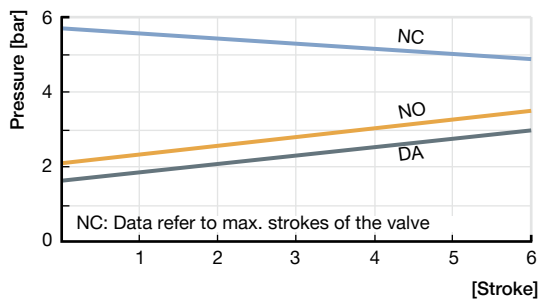

5. Ordering information

5.1. Bürkert eShop – Easy ordering and quick delivery



Bürkert eShop – Easy ordering and fast delivery

You want to find your desired Bürkert product or spare part quickly and order directly? Our online shop is available for you 24/7. Sign up and enjoy all the benefits.

[Order online now](#)

5.2. Bürkert product filter

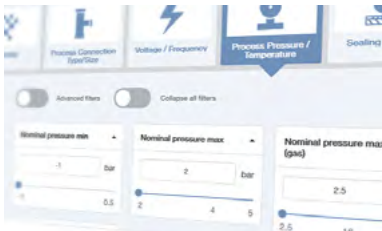

Bürkert product filter – Get quickly to the right product

You want to select products comfortably based on your technical requirements? Use the Bürkert product filter and find suitable articles for your application quickly and easily.

[Try out our product filter](#)

5.3. Ordering chart

Note:

- All valves with EPDM diaphragm
- The permissible nominal pressure decreases with increasing medium temperature (see “4.1. Pressure temperature diagram” on page 5).

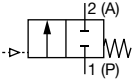
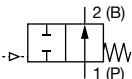
Control function	Orifice	K _v value water	Pressure range at +20 °C	Body material	Port connection	Article no.
	[mm]	[m³/h]	[bar]			
A, pneumatically operated on/off valve 2/2 way Flow direction above seat Normally closed by spring force 	12	2.8	0...6	PVC-U	Ø 16 true union solvent	784822
				PP	G 3/8 threaded socket	784824
	15	3.5	0...6	PVC-U	Ø 20 true union solvent	784826
				PP	Ø 20 true union weld	784832
B, single-acting actuator for pneumatically operated on/off valve 2/2 way Normally open by spring force 	12	2.8	0...6	PVC-U	Ø 16 true union solvent	784823
				PP	G 3/8 threaded socket	784825
	15	3.5	0...6	PVC-U	Ø 20 true union solvent	784827
				PP	Ø 20 true union weld	784833

5.4. Ordering chart accessories

3/2 way pilot valve

Type	Pressure inlet P (valve body)	Service port A (banjo bolt)	Orifice	Q _{Nn} value	Pres- sure range	Electrical connection industry standard	Power con- sumption	Article no. per Voltage/frequency	
				[mm]				[l/min]	[bar]
6012P ▶	Tube fitting Ø 6 mm	G ¼	1.2	48	0...10	Form B	4	552283	552286

Replacement diaphragms for all orifices

Description	Material	Article no.
Replacement diaphragms for all orifices	EPDM	789409
	FKM	789661
	EPDM/PTFE laminated	789597

Cable plug Type 2507 acc. to industry standard connector Form B

Note:

- Delivery of cable plug includes a flat seal and a fixing screw.
- Further versions of cable plug with circuitry acc. to industry standard connector Form B as well as detailed technical data, see datasheet **Type 2507 ▶**.

Cable plug	Version	Voltage	Article no.
	Without circuitry (standard)	2...250 V AC/DC	423845
	With LED	24 V AC/DC	423849
	With LED and free-wheeling diode	12...24 V AC/DC	423851
	With rectifier, LED and varistor	12...24 V AC/DC	423853

Bürkert – Close to You

For up-to-date addresses
please visit us at
www.burkert.com

DTS 1000020595 EN Version: F Status: RL (released | freigegeben | validé) printed: 17.12.2020

