



x|act ci

Precision Pressure Transmitter for Food / Beverage, Pharmaceutical Industry and Biotechnology

Ceramic Sensor

accuracy according to IEC 60770:
0.1 % FSO

Nominal pressure

from 0 ... 160 mbar up to 0... 20 bar

Output signals

2-wire: 4 ... 20 mA
others on request

Special characteristics

- ▶ Turn-Down 1:5
- ▶ hygienic version
- ▶ flush mounted, capacitive ceramic sensor
- ▶ several process connections (inch thread, Clamp, etc.)
- ▶ with integrated display and operating module
- ▶ diaphragm Al₂O₃ 99.9 %



Optional versions

- ▶ IS-version:
Ex ia = intrinsically safe version
- ▶ HART®-communication

The precise pressure transmitter x|act ci measures the pressure of gases, steam and fluids. The special-developed capacitive ceramic sensor for this transmitter, which can optionally be delivered in pure ceramic, has a high overpressure capability and excellent media stability.

Several process connections e.g. inch thread or hygienic versions like Varivent®, dairy pipe or Clamp are available. The robust stainless steel globe housing has a high ingress protection IP 67 and all characteristics for a residue-free and antibacterial cleaning.

Preferred areas of use are

-  Food and Beverage
-  Chemical and Petrochemical Industry
-  Laboratory Techniques

Preferred using in

-  Viscous and pasty media



Pressure ranges ¹								
Nominal pressure gauge	[bar]	0.16	0.4	1	2	5	10	20
Overpressure	[bar]	4	6	8	15	25	35	45
Permissible vacuum	[bar]	-0.3	-0.5			-1		
¹ On customer request we adjust the devices by software on the required pressure ranges (within the turn-down-possibility; starting at 0.02 bar).								
Output signal / Supply								
Standard	2-wire: 4 ... 20 mA / V _S = 12 ... 30 V _{DC}							
Option	2-wire: 4 ... 20 mA / V _S = 12 ... 28 V _{DC}							
IS-protection	2-wire: 4 ... 20 mA with HART® communication / V _S = 12 ... 28 V _{DC}							
IS-protection/ HART®	2-wire: 4 ... 20 mA with HART® communication / V _S = 12 ... 28 V _{DC}							
Current consumption	max. 25 mA							
Performance								
Accuracy ²	nominal pressure < 1 bar: ≤ ± 0,2 % FSO							
	nominal pressure ≥ 1 bar: ≤ ± 0,1 % FSO							
	for nominal pressure ranges: from 0.16 bar up to 0.4 bar				≤ ± (0.2 + (TD-1) x 0.02) % FSO			
	for nominal pressure ranges: from 1 bar up to 20 bar				≤ ± (0.1 + (TD-1) x 0.01) % FSO			
with turn-down = nominal pressure range / adjusted range								
Permissible load	R _{max} ≤ [(V _S - V _{S min}) / 0.02 A] Ω				load during HART® communication: R _{min} = 250 Ω			
Influence effects	supply: 0.05 % FSO / 10 V				permissible load: 0.05 % FSO / kΩ			
Long term stability	≤ ± 0.1 % FSO / year at reference conditions							
Response time	200 msec – without consideration of electronic damping						measuring rate 5/sec	
Adjustability	electronic damping: 0 ... 100 sec offset: 0 ... 80 % FSO turn-down of span: max. 1:5 (span min. 0.02 bar)							
² accuracy according to IEC 60770 – limit point adjustment (non-linearity, hysteresis, repeatability)								
Thermal errors / Permissible temperatures								
Thermal error	≤ ± (0.02 x turn-down) % FSO / 10 K in compensated range -20 ... 80 °C							
Permissible temperatures	medium: -25 ... 125 °C		environment: -20 ... 70 °C			storage: -30 ... 80 °C		
Electrical protection								
Short-circuit protection	permanent							
Reverse polarity protection	no damage, but also no function							
Electromagnetic compatibility	emission and immunity according to EN 61326							
Mechanical stability								
Vibration	5 g RMS (20 ... 2000 Hz)							
Shock	100 g / 11 msec							
Materials								
Pressure port	inch thread, DRD and flange version, Varivent®, dairy pipe and clamp: stainless steel 1.4404 (316L) optionally for G1 1/2" flush (DIN 3852): PVDF							
Housing	stainless steel 1.4301 (304)							
Viewing glass	laminated safety glass							
Seals	FKM (permissible temperature: -25 ... 125 °C) EPDM others on request							
Diaphragm	ceramics Al ₂ O ₃ 99.9 %							
Media wetted parts	pressure port, seals, diaphragm							
Explosion protection								
Approval AX12-x act ci	IBExU05ATEX1106 X zone 0/1 ³ : II 1/2G Ex ia IIC T4 Ga/Gb zone 20: II 1D Ex ia IIC T85 °C Da							
Safety technical maximum values	U _i = 28 V, I _i = 98 mA, P _i = 680 mW, C _i = 0 nF, L _i = 0 μH, the supply connections have an inner capacity of max. 27 nF to the housing							
Permissible temperatures for environment	in zone 0: -40 ... 60 °C with p _{atm} 0.8 bar up to 1.1 bar in zone 1 or higher: -40 ... 70 °C							
Connecting cables (by factory)	capacitance: signal line/shield also signal line/signal line: 160 pF/m inductance: signal line/shield also signal line/signal line: 1 μH/m							
³ The designation depends on the nominal pressure range. Nominal pressure ranges ≤ 60 mbar are marked with „2G“. For nominal pressure ranges > 60 mbar and < 10 bar see note under item 17 in the EC type-examination certificate!								

Miscellaneous	
Display	LC-display, visible range 32.5 x 22.5 mm; 5-digit 7-segment main display, digit height 8 mm, range of indication ± 9999 ; 8-digit 14-segment additional display, digit height 5 mm; 52-segment bargraph; accuracy 0.1% \pm 1 digit
Ingress protection	IP 67
Installation position	any
Weight	min. 400 g (depending on mechanical connection)
Operational life	> 100 x 10 ⁸ pressure cycles
CE-conformity	EMC Directive: 2014/30/EU
ATEX Directive	2014/34/EU

Wiring diagram

2-wire-system (current)

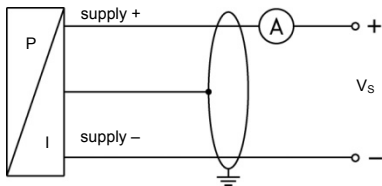

2-wire-system (current) HART®

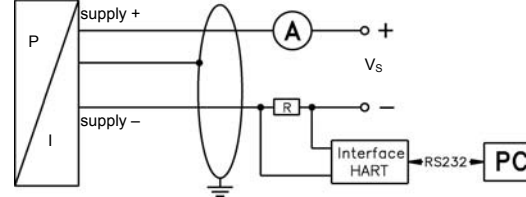

Pin configuration

Electrical connections	M12x1 (4-pin)	cable colours (IEC 60757)
Supply +	1	wh (white)
Supply -	3	bn (brown)
Shield	plug housing	gnye (green-yellow)

Electrical connections (in mm)

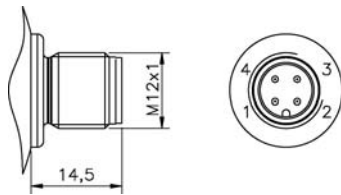

M12x1 (4-pin)

Designs ⁴

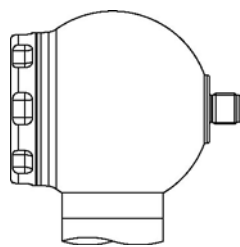

side display

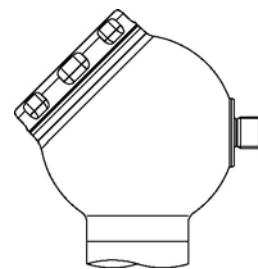
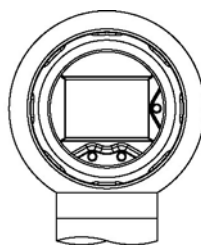

45° display

⁴ all designs in combination with G1 1/2" flush in horizontal rotatable housing as standard; other mech. connections in rotatable housing on request

Dimensions (in mm)

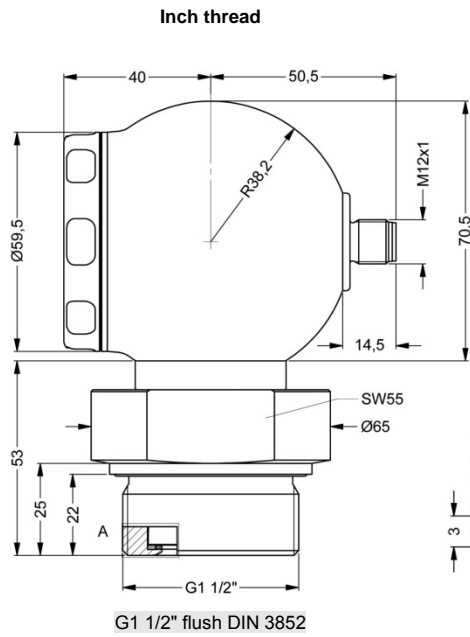

Clamp (DIN 32676)

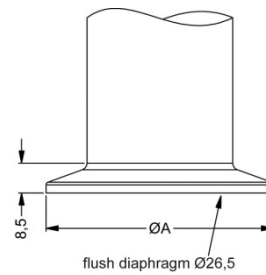

dimensions in mm		
size	DN32	DN50
A	50,5	64
P _N [bar]	≤ 16	≤ 16

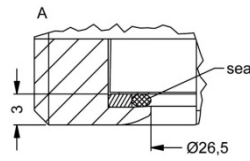

Dairy pipe⁶ (DIN 11851)

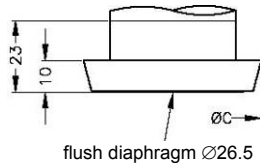

dimensions in mm		
size	DN 40	DN 50
C	56	68,5

Varivent[®]

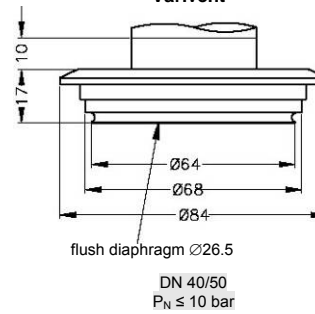

Flange (DIN 2501)

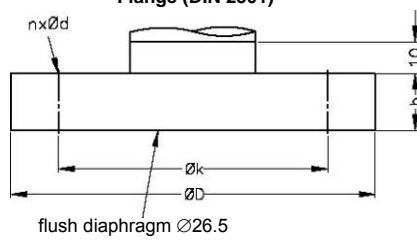

dimensions in mm			
size	DN25	DN50/PN40	DN80
D	115	165	200
k	85	125	160
b	18	20	20
n	4	4	8
d	14	18	18
P _N	≤ 40 bar	≤ 40 bar	≤ 16 bar

DRD⁵

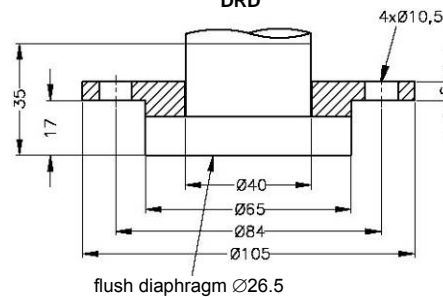

⁵ cup nut for dairy pipe or mounting flang for DRD is included in the delivery (already pre-assembled)

HART[®] is a registered trade mark of HART Communication Foundation;

Varivent[®] is a trademark of GEA Tuchenhausen GmbH; Windows[®] is a registered trade mark of Microsoft Corporation

