

NOZZLE SCHEDULE			
ITEM	QTY.	NAME	DESCRIPTION
N1	1	INLET	2"-150# RESO ASME B16.5 W/ STD WT PIPE
N2	1	OUTLET	2"-150# RESO ASME B16.5 W/ STD WT PIPE
N3	1	DRAIN	1" NPT 3000# COUPLING

REV	DATE	CHANGE	ECR	BY	APP
A	08/13/98	NEW RELEASE	6573	AB	FEJ
B	08/17/98	DWG SIZE WAS "B"	6584	AB	DP
C	12/05/03	DELETED NAMEPL, BRACKET, NAMEPL, INLET TAG, ADDED EXHAUST HEAD NAMEPL.	B982	LH	FM
D	11/1/05	REVISED TITLE BLOCK	D507	FM	LH

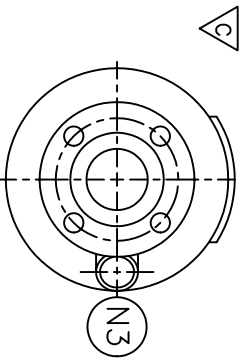
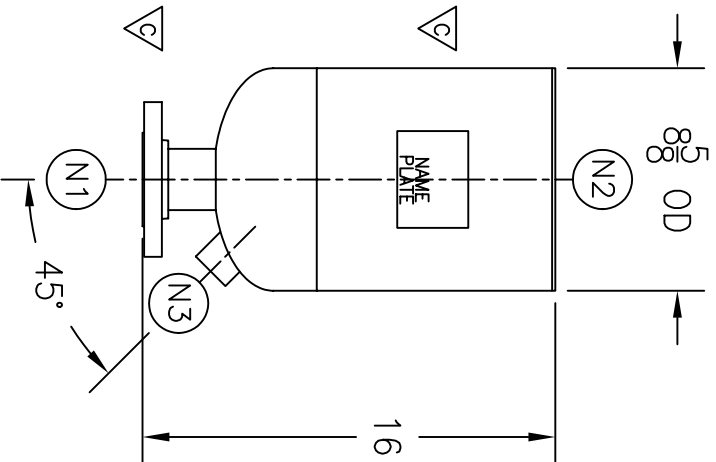

NOTES:

1. ALL DIMENSIONS ARE IN INCHES.
2. ALL BOLT HOLES ARE TO STRADDLE NATURAL CENTERLINES.
3. SHIPPING WEIGHT: 60 POUNDS.
4. DESIGN DATA:
 DESIGN PRESSURE- ATMOSPHERIC
 DESIGN TEMPERATURE- AMBIENT
 CORROSION ALLOWANCE- 0 INCHES
5. MATERIAL : 304L STAINLESS STEEL.

CUSTOMER:
 REG. NO.:
 P.O. NO.:
 TAG NO.:
 PART NO.: 2EHS

ELECTRONIC FILE NAME:
 SD2EHS.DWG
 TOLERANCES UNLESS OTHERWISE SPECIFIED
 PER ENGINEERING STANDARD ES- --

UNAUTHORIZED USE, MANUFACTURE OR
 REPRODUCTION IN WHOLE OR IN PART IS
 PROHIBITED. DRAWING, DESIGN AND
 OTHER DISCLOSURES PROPERTY OF
 EATON FILTRATION, LLC

		EATON FILTRATION, LLC 900 FAIRMOUNT AVENUE, ELIZABETH, NEW JERSEY 07207							
		NAME 2" TYPE "EHMF" EXHAUST HEAD 150# FLG 304L SSTL							
DRAWN	AB	DATE	08/12/98	CHECKED	DP	DATE	08/13/98		
APP	FEJ	DATE	08/13/98	SCALE	NTS	ECR	6573		
SIZE	A	DWG	NO	SD2EHS				REV	D