

NOZZLE SCHEDULE		REV	DATE	CHANGE	ECR	BY	APP
ITEM	QTY.	NAME	DESCRIPTION				
N1	1	INLET	12" - 150# RESO ASME B16.5	A	01/13/99	NEW ISSUE	7081 AB DP
N2	1	OUTLET	12" STD WT PIPE	B	12/05/03	DELETED NAMEPL. BRACKET, NAMEPL., INLET TAG, ADDED EXHAUST HEAD NAMEPL.	B892 LH FM
N3	1	DRAIN	2-1/2" NPT 3000# COUPLING	C	11/1/05	REVISED TITLE BLOCK	D507 FM LH

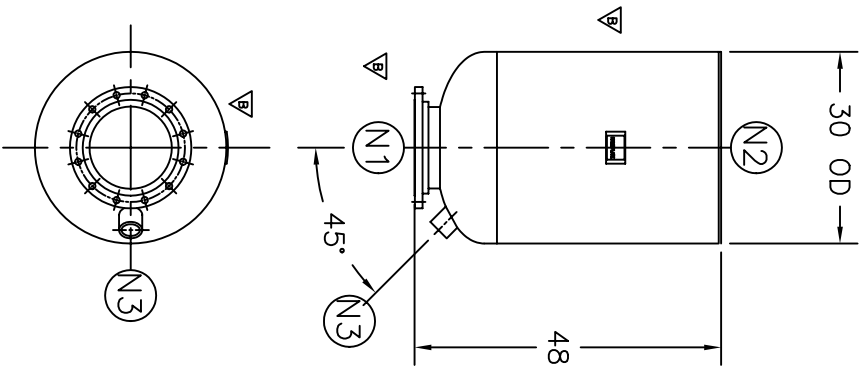

NOTES:

1. ALL DIMENSIONS ARE IN INCHES.
2. ALL BOLT HOLES ARE TO STRADDLE NATURAL CENTERLINES.
3. SHIPPING WEIGHT: 575 POUNDS.
4. DESIGN DATA:
 DESIGN PRESSURE- ATMOSPHERIC
 DESIGN TEMPERATURE- AMBIENT
 CORROSION ALLOWANCE- 0 INCHES
 MATERIAL: CARBON STEEL.

CUSTOMER:
 REG. NO.:
 P.O. NO.:
 TAG NO.:
 PART NO.: 12EHC

ELECTRONIC FILE NAME:
 SD12EHC.DWG
 TOLERANCES UNLESS OTHERWISE SPECIFIED
 PER ENGINEERING STANDARD ES- ---

UNAUTHORIZED USE, MANUFACTURE OR
 REPRODUCTION IN WHOLE OR IN PART IS
 PROHIBITED. DRAWING, DESIGN AND
 OTHER DISCLOSURES PROPERTY OF
 EATON FILTRATION, LLC



EATON FILTRATION, LLC
 900 FAIRMOUNT AVENUE, ELIZABETH, NEW JERSEY 07207
 NAME 12" TYPE "40-EHMF" EXHAUST
 HEAD 150# FLG CSTL

DRAWN	AB	DATE	01/13/99	CHECKED	DP	DATE	01/13/99
APP	---	DATE	---	SCALE	NTS	ECR	7081
SIZE	A	DWG	NO	SD12EHC		REV	C