

NOZZLE SCHEDULE				
ITEM	QTY.	NAME	DESCRIPTION	
N1	1	INLET	8"-150# RFSO ASME B16.5	
N2	1	OUTLET	8"-150# RFSO ASME B16.5	
N3	1	DRAIN	2" NPT 3000# COUPLING	
N4	1	VENT	1/2" NPT 3000# COUPLING	

REV	DATE	CHANGE	ECR	BY	APP
A	06/19/06	NEW ISSUE	E021	GO	LH

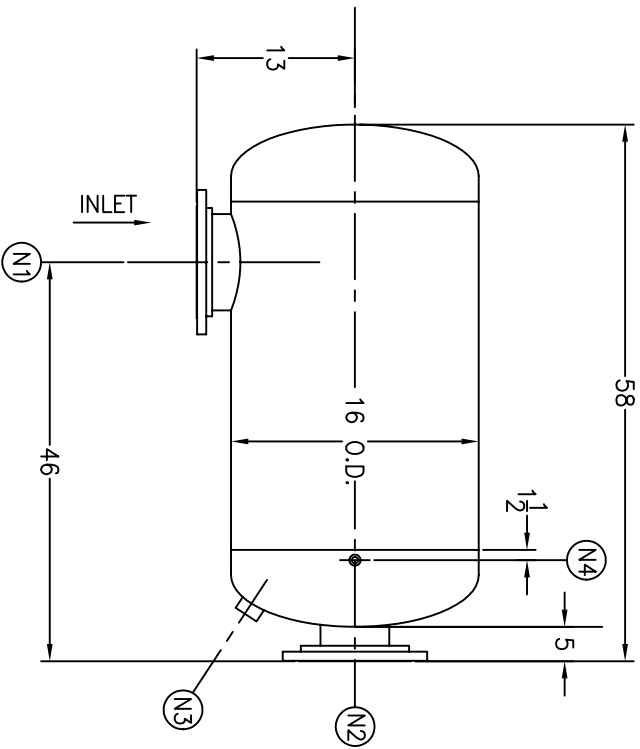

NOTES:

- UNITS ARE TO BE DESIGNED, FABRICATED, AND "U" STAMPED (IF REQ'D) IN ACCORDANCE WITH ASME B & PV CODE, SECTION VIII, DIVISION 1 IN COMPLIANCE TO CURRENT PUBLISHED ADDENDA.
- ALL DIMENSIONS ARE IN INCHES.
- ALL BOLT HOLES ARE TO STRADDLE NATURAL CENTERLINES.
- SHIPPING WEIGHT: 500 POUNDS
- DESIGN DATA:
 DESIGN PRESSURE-- 150 PSIG
 DESIGN TEMPERATURE-- 450° F
 MIN. DESIGN METAL TEMP.-- -20° F @ 150 PSIG
 HYDROTEST PRESSURE-- 195 PSIG
 CORROSION ALLOWANCE-- 0 INCHES
- RADIOGRAPHY REQUIREMENTS: NONE
- PAINT REQUIREMENTS: SEE B.O.M
- MATERIAL: CARBON STEEL

STANDARD

CUSTOMER:
 REG. NO.:
 P.O. NO.:
 TAG NO.:
 PART NO.: 836L150C, 836L150CU



EATON FILTRATION, LLC
 900 FAIRMOUNT AVENUE, ELIZABETH, NEW JERSEY 07207
 NAME
8" TYPE "36-L" GAS/LIQUID SEPARATOR 150# FLG CSTL

ELECTRONIC FILE NAME:
 SD836L150C.DWG

TOLERANCES UNLESS OTHERWISE SPECIFIED
 PER ENGINEERING STANDARD ES- - - -

UNAUTHORIZED USE, MANUFACTURE OR
 REPRODUCTION IN WHOLE OR IN PART IS
 PROHIBITED. DRAWING, DESIGN AND
 OTHER DISCLOSURES PROPERTY OF
 EATON FILTRATION, LLC

DRAWN	GO	DATE	06/19/06	CHECKED	FM	DATE	06/19/06	
APP	LH	DATE	06/19/06	SCALE	NTS	ECR	E021	
SIZE	DWG	NO						
SD836L150C							REV	A